

porodo



# Porodo LifeStyle A4 Thermal Printer

SKU: PD-LFA4TP-WH

# Table of Contents

Specifications	2
Schematic View	3
Indicator Guidelines	4
App Connectivity	4
Driver Installation	6
Instructions for Use	9
Paper Roll Installation Guide	9
Folded Paper Installation Guide	10
Maintenance	10
Warning	11
Safety Precautions	11
Warranty	12
Contact Us	12

Before installing and using the product, please carefully read this User Manual to guarantee correct usage and keep it secure for future reference.

## Specifications

SKU	PD-LFA4TP-WH
FCC ID	2A6FW-A80
Dimensions	11.3×4.3×4.3inches
Weight	17lbs
Printing Method	Direct Thermal
Resolution	203dpi
Maximum Printing Speed	15mm/s
Input	AC 100V to 240V, 50 to 60Hz
Battery Capacity	2550mAh
Output	5V/2A
Human-Machine Interface	Key LED Indicator Drive
Communication Interface	USB/Bluetooth 2.0 & 4.0
Operating Temperature (°C)	0°C to +40°C
Working Humidity	30 % to 85 % RH (No Condensation)
Storage Temperature (°C)	-20°C to +60°C
Storage Humidity	0 % to 90 % RH (No Condensation)

## Schematic View

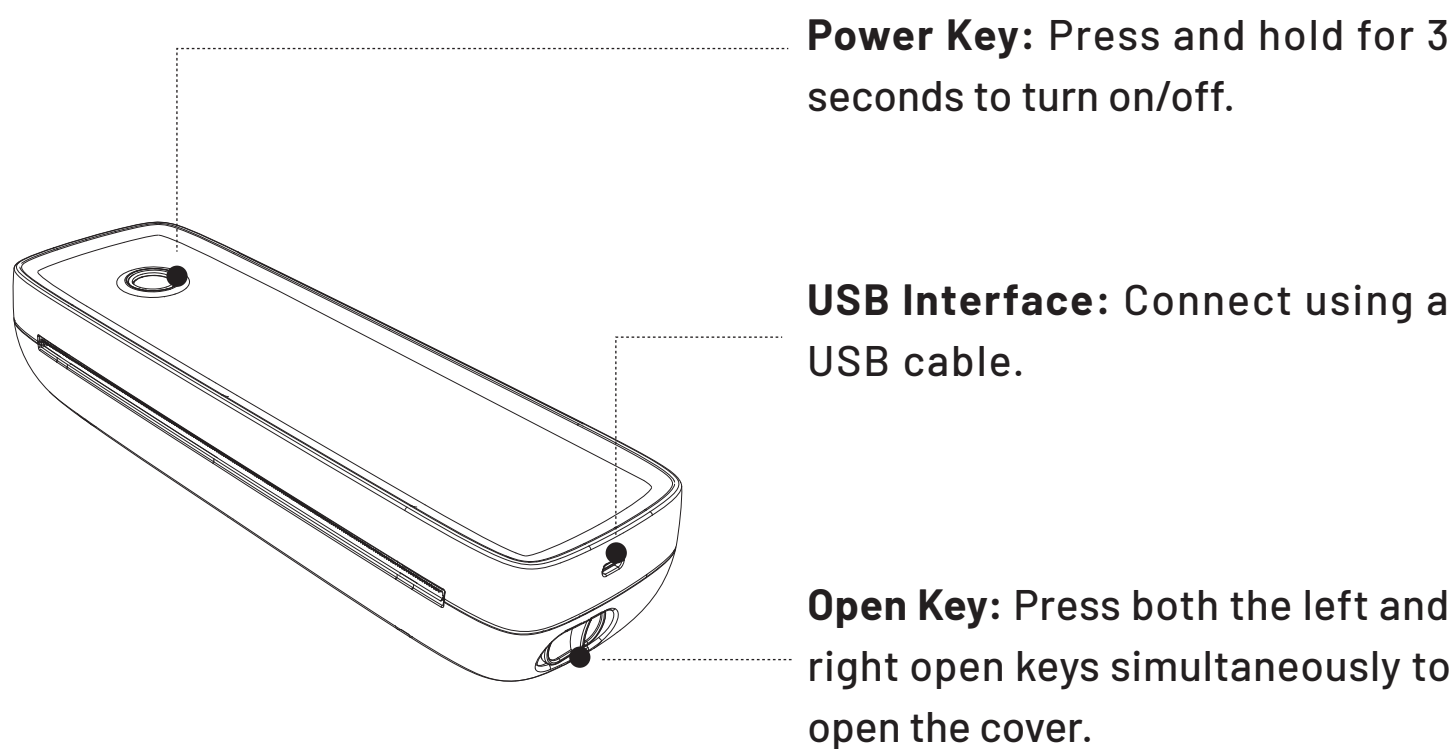
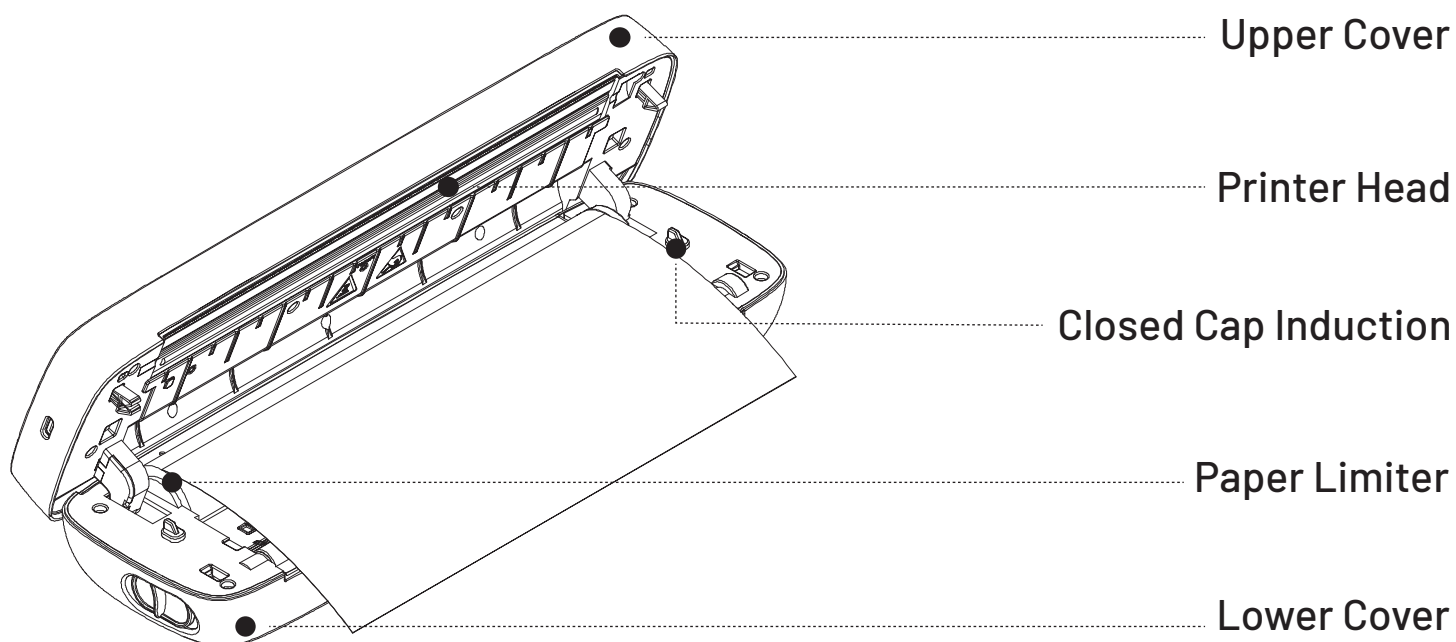

## Indicator Guidelines

Status	Description	Troubleshoot
Green	Normal Operation	—
Flashing Red and Green	Printer Head is Overheated	Printer Overheating: The printer will automatically resume operation once the printer head has cooled down.
Red	1. Charging 2. Top Cover Open 3. No Paper	Charging: Indicator: When fully charged, the indicator light turns green. Top Cover: Ensure the top cover is closed correctly.
Flashing Red	Low Electricity Supply	Charge the Printer
Blue	Bluetooth Pairing Successful	Bluetooth Connected Successfully
Flashing Blue	Bluetooth is Initializing or Initialization Failed	App and Bluetooth Connection: Close the app first. Restart the printer and wait for the blue light to stop flashing. Then reconnect the app.

## App Connectivity

**1. Download App:** Scan the QR code to download the SharpFox App.

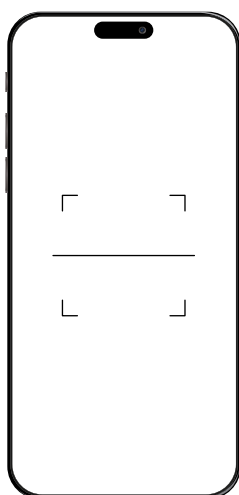

## 2. Enable Settings:

**iOS:** Turn on Bluetooth and allow the SharpFox App to access.

**Android:** Turn on Bluetooth and Location, and allow the SharpFox App to access.

iOS Device



Android Device



**3. Connect Device:** Open the SharpFox App and tap "Connect Device."

**4. Connect Printer:** Connect the thermal printer device.

**5. Select Paper Settings:** Tap the paper type and paper width.

**6. Save Settings:** Choose the paper type and paper width. Tap save. (To customize the paper width, enter the number in the last row.)

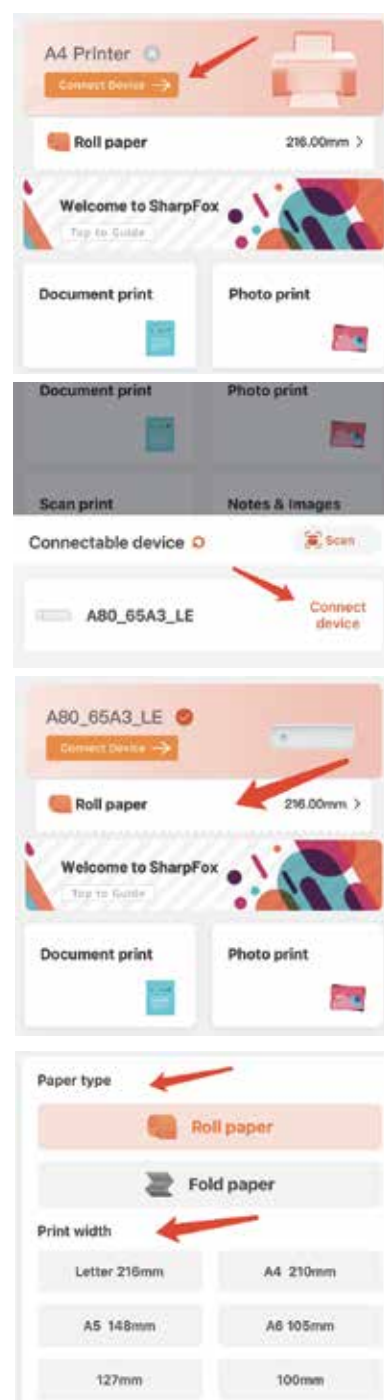

## 7. Select Printing Option:

- Document Print: Import files from other apps – Word, PDF, Excel, PowerPoint, TXT.
- Photo Print: Import files from the photo album.
- Scan Print: Take a photo you need to print.

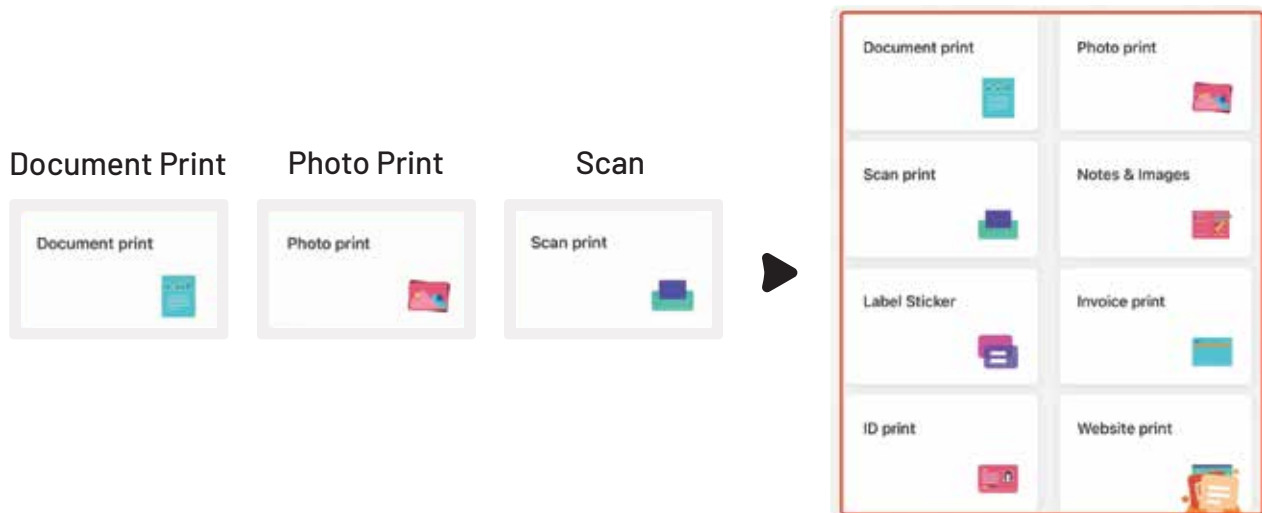

## Driver Installation

### 1. Windows

**1.1** Power On the Printer: Activate the printer to get it ready for installation.

**1.2** Connect the Printer to Your Computer: Use a USB cable to link the printer to your computer.

**1.3** Download the Driver: Visit the product page on the Porodo website. Select the appropriate driver for your operating system by clicking on "Windows Driver".

**1.4** Install the Printer Driver: Download and extract the contents of the downloaded file. Run "PD-LFA4TPA4-Windows-Driver-Latest\_Ver1.2.3.5.exe" for Windows. Follow the on-screen instructions to complete the setup.

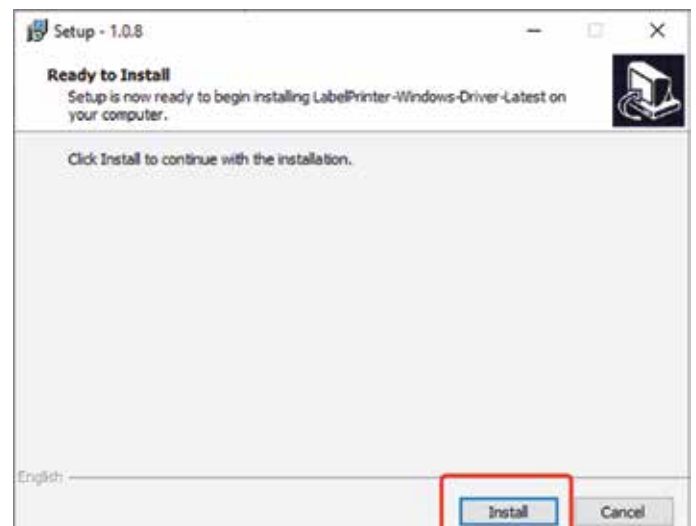
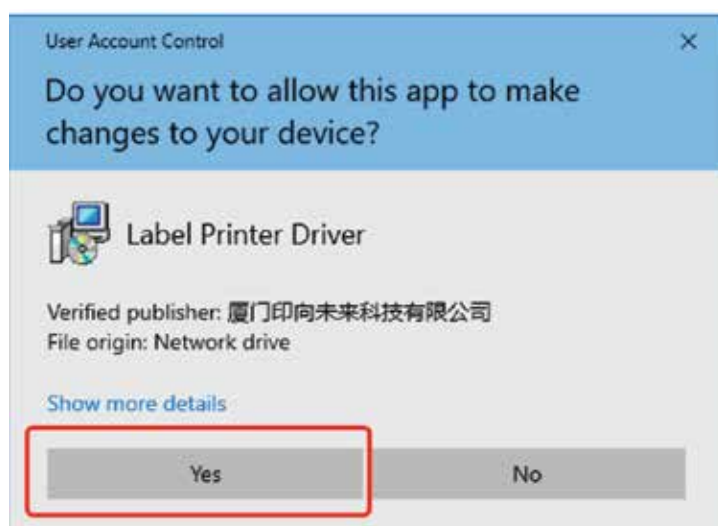

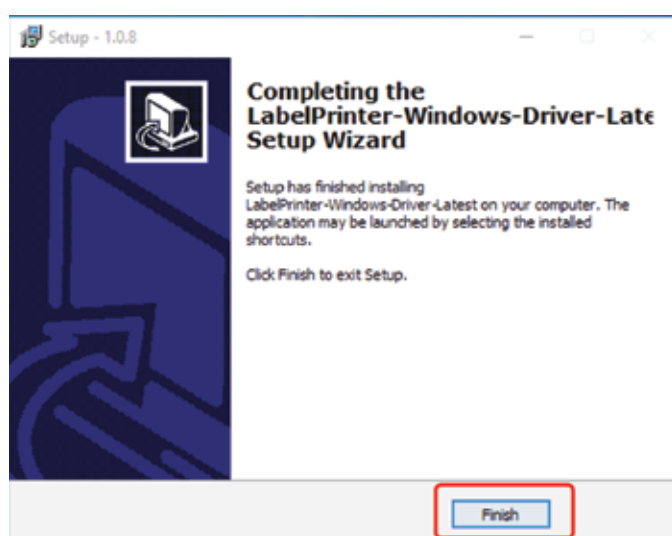
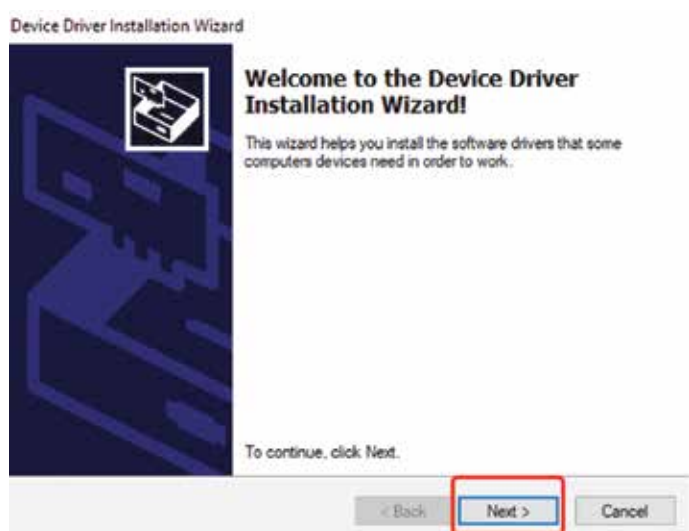

## 2. Mac OS

**2.1** Power On the Printer: Activate the printer to get it ready for installation.

**2.2** Connect the Printer to Your Computer: Use a USB cable to link the printer to your computer.

**2.3** Download the Driver: Visit the product page on the Porodo website. Select the appropriate driver for your operating system by clicking on "MAC Driver."

**2.4** Install the Printer Driver: Download and run "MACOS\_Driver\_PD-LFA4TP.pkg". Follow the on-screen instructions to complete the setup.

**2.5** Open "System Preferences" and click "Printers & Scanners". In case that you observe the printer's name in list it means that your printer has been installed successfully.



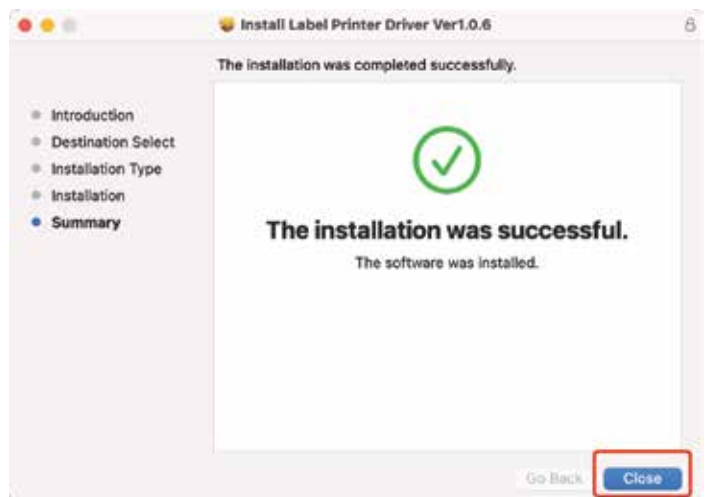
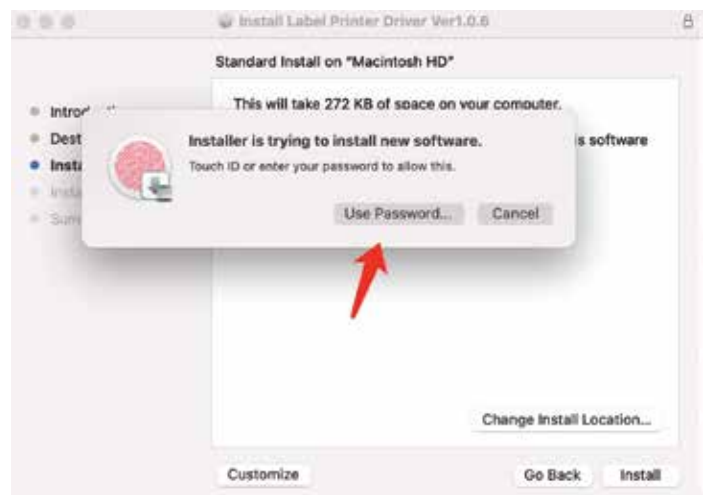
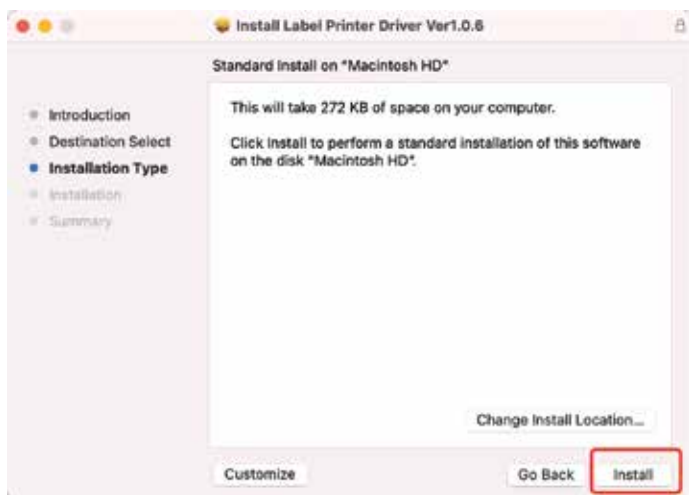
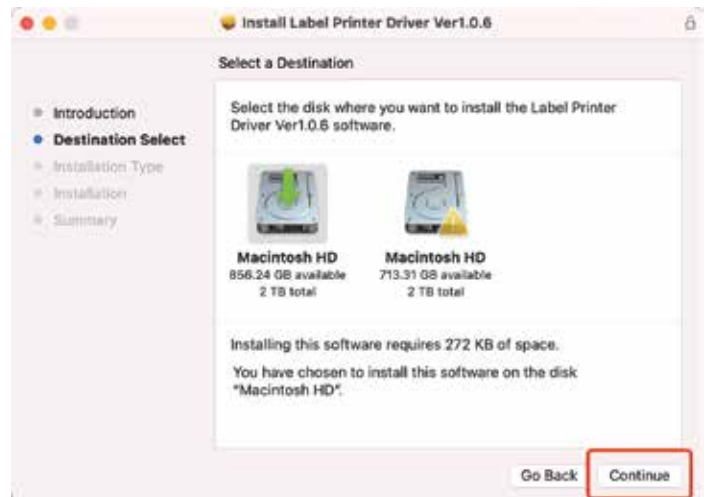

## Instructions for Use

Please adjust the paper limiter to match your preferred paper width, ranging from 2.24 inches to 8.5 inches.

**Note:** that the thermal printer will automatically power off after 15 minutes of inactivity.

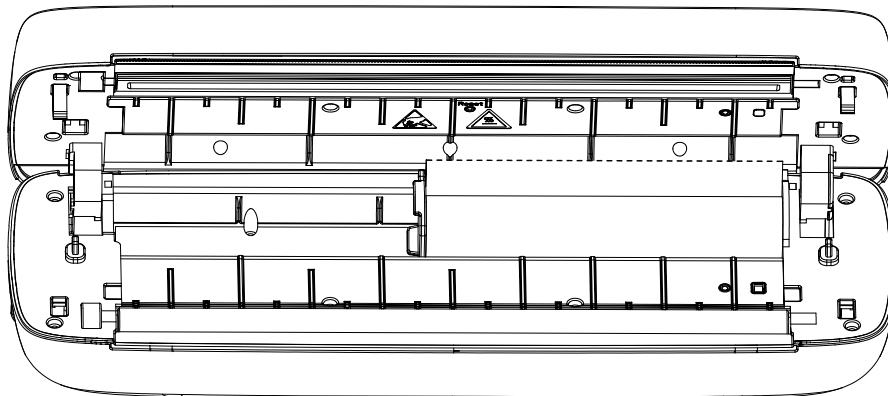

## Paper Roll Installation Guide

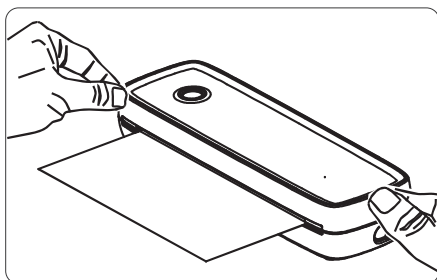

1. Press the designated open key buttons to access the printer cover.

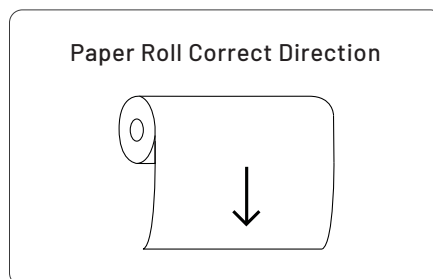

2. Confirm the correct direction of the thermal paper roll.

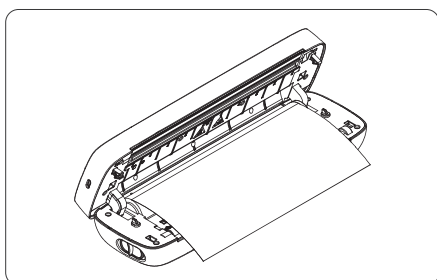

3. Place the thermal paper, ensuring that the end of the paper is exposed to the machine.

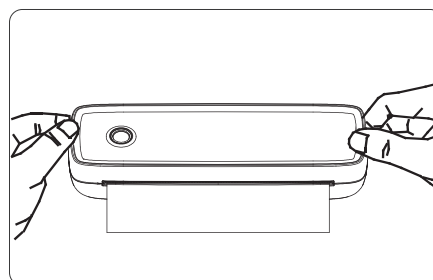

4. Securely close the printer cover.

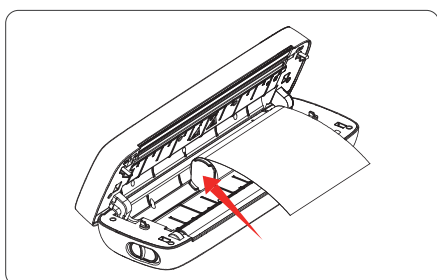

5. Should paper width adjustment be necessary, gently push the paper limiter against the edge of the paper roll.

## Folded Paper Installation Guide

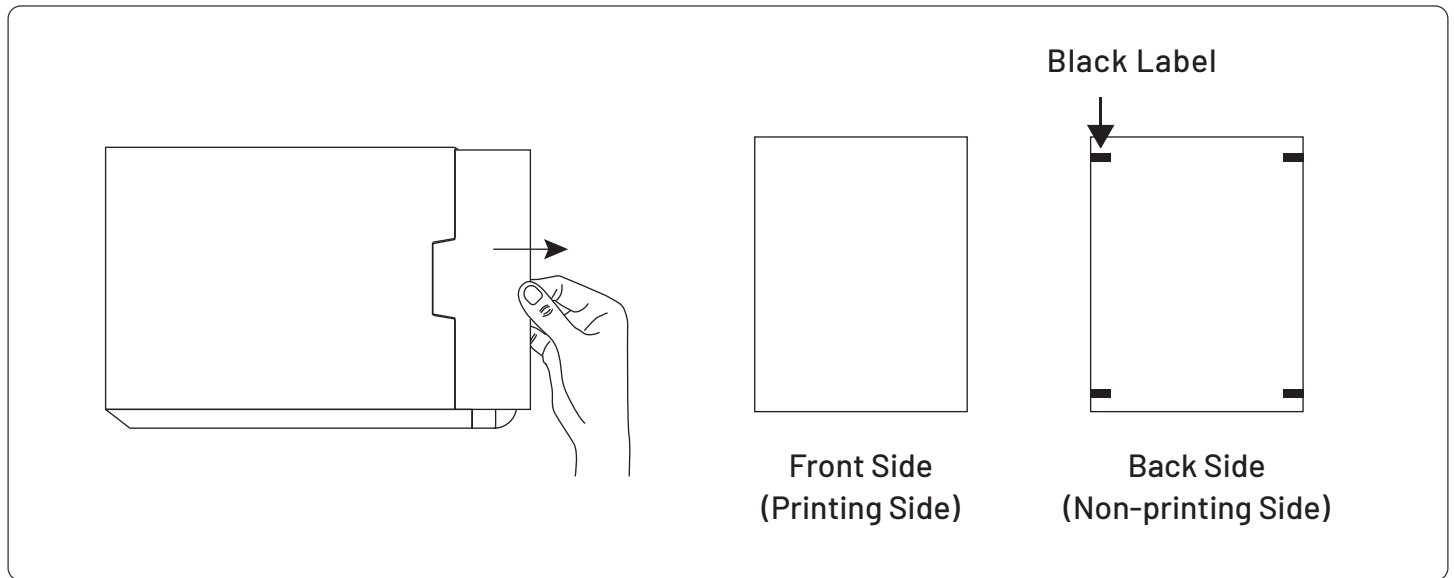

**1.** Retrieve the thermal paper from the printer, ensuring you identify the printing side.

**Note:** Make sure the paper roll is taken out from the thermal printer.

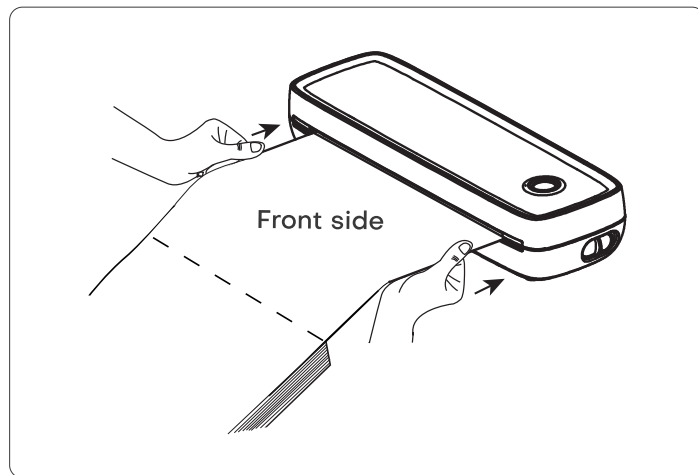

**2.** Orient the front side of the thermal paper and align it with the paper inlet of the printer. Insert the paper, ensuring it adheres securely within the printer for smooth printing operations.

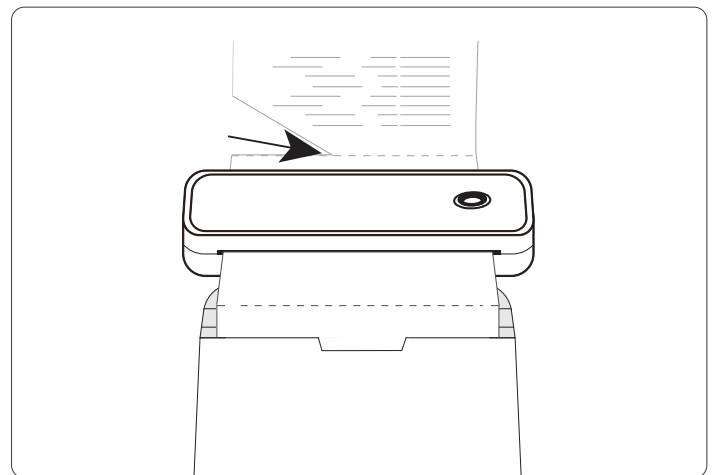

**3.** Tear off any excess paper to prepare it for use.

## Maintenance

**1.** Please power off the printer, open the printer cover, and remove the paper roll.

2. Dip a cotton cloth or cotton swabs into medical alcohol, and gently wipe the printing head from the center outward.
3. After cleaning the print head, do not use the printer immediately. Allow 1-2 minutes for the alcohol to completely evaporate before resuming operation.

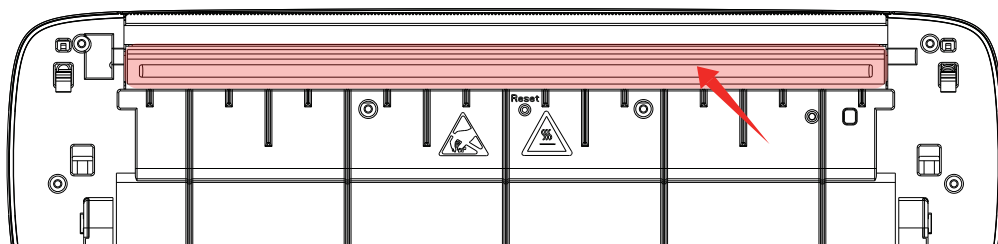

## **Warning**

1. This product does not include a power adapter. If you need to use a power adapter to charge, please purchase a certified 5V/2A power adapter that complies with the necessary standards.
2. As this is a professional product, please use the original battery.

## **Safety Precautions**

1. The device contains a built-in lithium battery. Do not use it in environments with temperatures exceeding 40°C. Avoid exposure to fire and other heat sources, and do not leave it in direct sunlight or in enclosed areas such as a closed vehicle.
2. The device should be operated and charged under adult supervision when used by children. Ensure that the charging cable is disconnected after the device is fully charged to prevent overheating, short circuits, or fire.
3. Avoid placing the product in fire or water as this could lead to a battery short circuit or cause a fire.
4. The recommended working environment for the device is between 0°C and 40°C with a relative humidity of 30 %– 85 % RH in a non-condensing atmosphere. Please do not exceed these temperature and humidity limits.

**Note:** If you suspect that there is a problem with the battery, please contact the authorized service assistance.

## **Warranty**

Products that you buy directly from our **Porodo** website or shop come with a 24-month warranty.

When you buy **Porodo** products from any of our approved sellers, you only get a 12-month warranty. If you want to extend this warranty, go to our website at **<https://porodo.net/warranty>** and fill out the form with your information. Don't forget to upload a picture of the product too. After we've checked and accepted your request, we'll send you an email to confirm that your product's warranty has been extended.

For more info, please check:

**<https://www.porodo.net/warranty>**

## **Contact Us**

If you have any questions about this Privacy Policy, please contact us at:

**[info@porodo.net](mailto:info@porodo.net)**

Website: **[porodo.net](https://porodo.net)**

Service Support: **[support@porodo.net](mailto:support@porodo.net)**

Instagram: **[porodo](https://www.instagram.com/porodo)**