

**PORODO**  
**LIFESTYLE**



**Porodo Lifestyle**

**Electric Toothbrush**

SKU: PD-LFST094

# **Table of Contents**

Important Safety Information	2
Usage Prohibitions	2
Product Overview	3
Specifications	4
Instructions for Use	4
Mode Adjustment	5
Charging Instructions	5
Maintenance	7
Environmental Protection Statement	7
Warranty	8
Contact Us	8

## Important Safety Information

Before using the product, please read this important information carefully and keep it for future reference.

1. If your mouth or gums have undergone surgery within the past two months please consult your dentist before use.
2. If you have a heart rate modulator, pacemaker, or other medical devices or implants, please consult your doctor or the manufacturer of the device.
3. Do not use toothbrush heads that are not recommended by our company.
4. This product is intended solely for cleaning teeth and gums and should not be used for other purposes.
5. To effectively prevent the growth of bacteria on the bristles and ensure oral health, the bristles should be replaced every three months.
6. When the bristles are visibly worn, it is also advisable to replace them.
7. This product is intended for individuals aged 6 years and older. Ensure that it is used appropriately based on the recommended age group to prevent misuse.

## Usage Prohibitions ☹

1. If the product is visibly damaged prior to use, it should not be used under any circumstances.
2. This product contains a built-in rechargeable battery. Never expose the product to fire, excessive heat, or high temperatures. Do not charge or use the product in such conditions.
3. It is strictly prohibited to attempt to disassemble, modify, or repair the product by yourself.
4. The product should only be charged within an ambient temperature range of 0°C to 40°C.
5. Before removing the battery, ensure that the product is powered off.
6. Batteries must be handled with utmost care and in accordance with safety guidelines.

**Note:** Even individuals with healthy teeth may experience a mild tingling sensation

or slight bleeding when using the electric toothbrush for the first time. This is a normal response as the teeth are not accustomed to the stimulation. This effect should resolve within 2-1 weeks. If the condition persists beyond two weeks discontinue use and consult your dentist.

## Product Overview

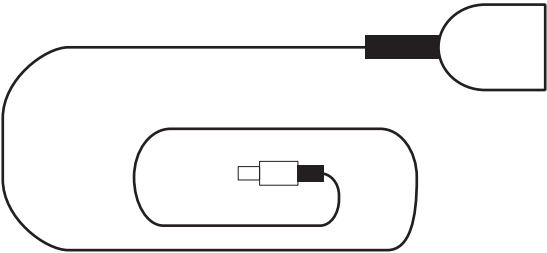

USB charging cable

## Specifications

Battery Capacity	500mAh
Rated Power	0.5Wh
Input Voltage	5V/1A
Working Time	Up to 50 days
Charging Interface	Type-C
Bristles	Pedex Nylon 612
Vibration Frequency	19000 to 20000 Stroke/Minute
Product Size	24.8×25.2×222mm
Standard	IPX7

## Instructions for Use

1. Insert the brush head vertically into the handle, ensuring it is securely positioned between the brush head and the handle.  
**Note:** A small gap may be present between the brush head and the handle.
2. Wet the brush head and apply an appropriate amount of toothpaste.
3. Gently press the brush head against the junction of your teeth and gums ensuring proper contact for effective cleaning.

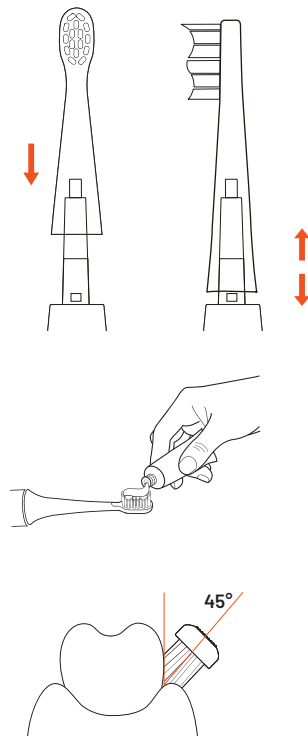

4. Press the mode button to select the desired brushing mode, and gently move the toothbrush head back and forth between your teeth.
5. The toothbrush operates intelligently for 2 minutes, pausing every 30 seconds to prompt you to change to the next section of your mouth.
6. After brushing, rinse the toothbrush head under flowing clear water and shake off any excess water from the brush head.

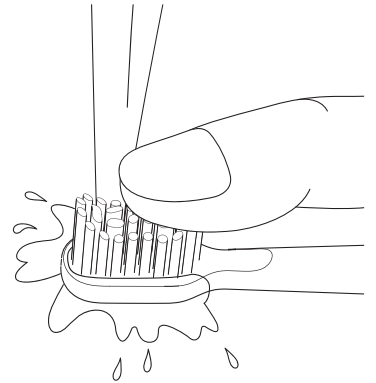
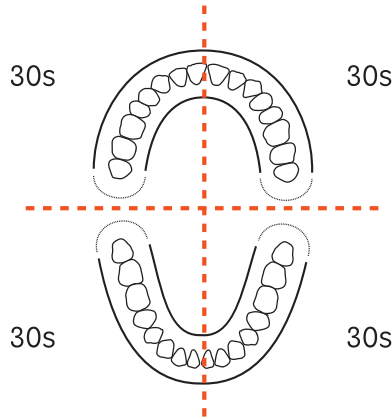
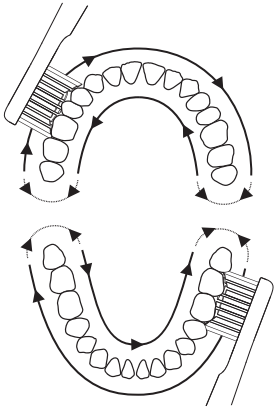

## Mode Adjustment

When switching to a new mode, the device defaults to the lowest intensity level indicated by a green light. Press the mode button again to increase the intensity to a higher level, at which point the intensity indicator will turn red.

1. **Soft Mode:** This mode provides a gentle experience, designed specifically for sensitive teeth and gums.
2. **Clean Mode:** This mode effectively removes dental plaque (default mode). It lasts for 2 minutes, including four 30-second intervals for changing areas.
3. **Polish Mode:** This mode is designed to brighten and polish the front teeth.
4. **Mild Mode:** In this mode, the toothbrush operates in a gentle manner to protect sensitive teeth and gums.
5. **White Mode:** This mode helps thoroughly clean the teeth and effectively remove plaque.

## Charging Instructions

1. Plug the charger directly into the power socket to begin charging.
2. When the battery power is insufficient, the charging indicator light will flash

red, indicating that the product needs to be charged.

**3.** The charging indicator light will remain red and bright while the product is charging.

**4.** Once fully charged, the charging indicator light will turn green and remain bright, with no flashing.

**5.** While charging, the handle and base may feel slightly warm. This is a normal occurrence. Always use the original standard charger to charge the product to avoid potential hazards.

**6.** After charging is complete, please remove the charger to prevent overheating which could result in damage to components or create a risk of electric shock.

**7.** Before connecting the charger to the power supply, ensure that the voltage marked on the product is consistent with the local power supply voltage.

**Danger:** Keep the charger away from any water sources. Do not place or store it above or near any container with water, such as a bathtub, washbasin, pool etc. Do not immerse the charger in water or any other liquid. After cleaning ensure the charger is completely dry before reconnecting it to the power supply.

**Warning:** Do not attempt to replace the power cord. If the power cord is damaged discard the charger immediately. Always use the original charger model for charging to avoid potential hazards. If the product (brush head, toothbrush handle, or charger) is damaged, discontinue use. Charge the product only with an adapter that has an output voltage of 5V and 1A. If the charger's output voltage exceeds the recommended value, it could cause damage to the product or pose a danger.

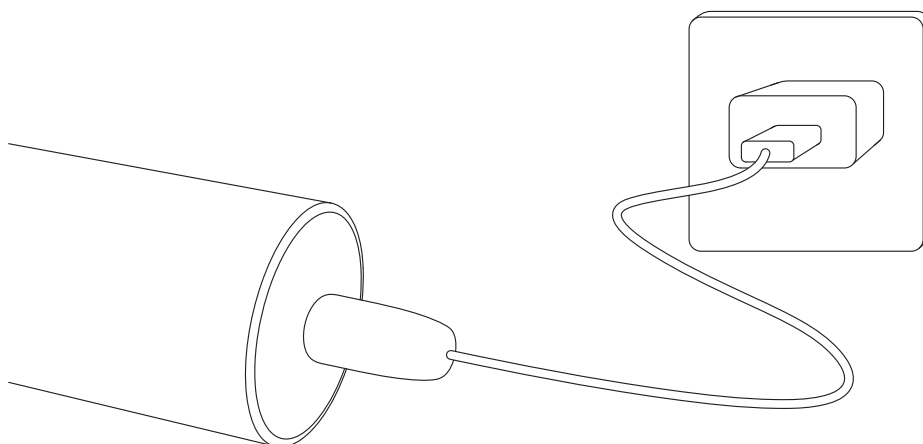

## Maintenance

1. Always turn the brush head downward when cleaning it to prevent water from entering the handle.
2. After each use, clean the bristles and brush head, and allow them to dry naturally.
3. Avoid pulling on the bristles, as this may cause them to deform.
4. When cleaning the main toothbrush unit:
  - 4.1 Dry the toothbrush handle with a dry cloth.
  - 4.2 Do not soak the toothbrush in water for extended periods.
  - 4.3 Avoid using water or acidic cleaning liquids above 40°C to clean the toothbrush.

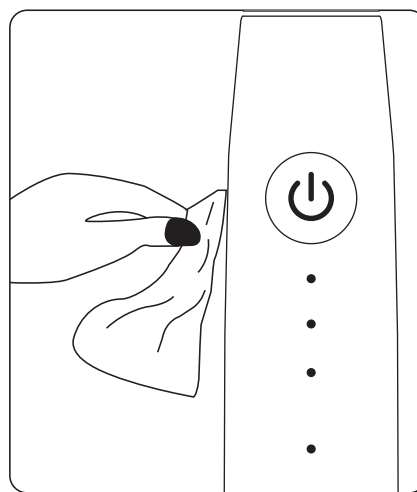
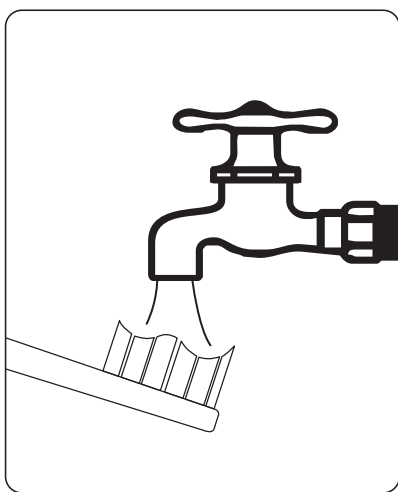

## Environmental Protection Statement



The electric toothbrush is equipped with a built-in rechargeable Li-ion battery. When disposing of this product, do not discard it with general household waste. Please remove the battery and dispose of it at an authorized battery recycling center, as designated by local regulations. This helps contribute to environmental protection.

## **Warranty**

Products that you buy directly from our **Porodo** website or shop come with a 24-month warranty.

When you buy **Porodo** products from any of our approved sellers, you only get a 12-month warranty. If you want to extend this warranty, go to our website at **porodo.net/warranty** and fill out the form with your information. Don't forget to upload a picture of the product too. After we've checked and accepted your request, we'll send you an email to confirm that your product's warranty has been extended.

For more info, please check:  
**porodo.net/warranty**

## **Contact Us**

If you have any questions about this Privacy Policy, please contact us at:

**info@porodo.net**

Website: **porodo.net**

Service Support: **support@porodo.net**

Instagram: **porodo**