

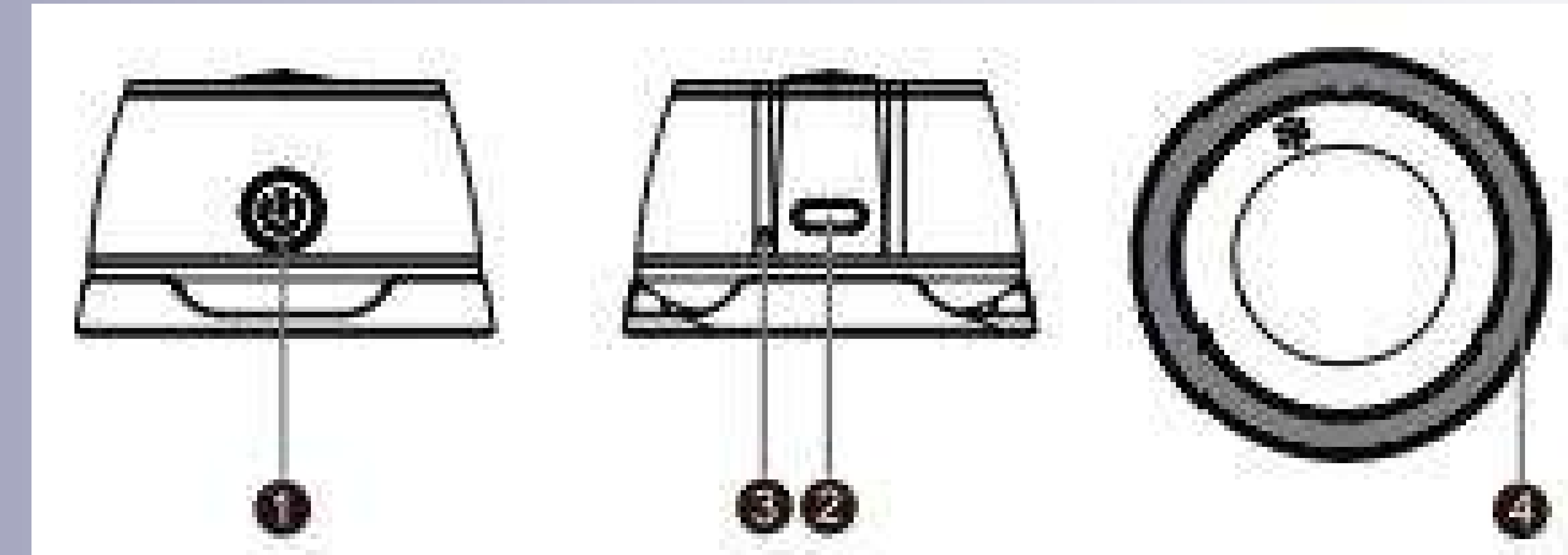

Magnetic Suction 3W Speaker  
RGB LED Light Effect  
SKU:PD-STMS3W

## Product Overview



Power Button (On/Off, Play/Pause)  
Type-C Charging Port  
Charge Indicator  
Magnetic Base

## Specifications

Power Output: 3W  
Input: DC5V, 500mA  
Speaker Driver: 40mm  
Battery Capacity: 3.7V/400mAh  
Operating Distance: 10M  
Dimensions: 36\*57mm



# Functions

## Bluetooth Connection:

- Activate the speaker by pressing the Power ON/OFF button for 5 seconds.
- The LED will flash as the device becomes discoverable.
- Search for "ST-Charme" on your mobile device and select it once found.
- A confirmation tone signals a successful connection.
- The speaker will power off automatically after 10 minutes of inactivity to save battery.

## During Playback:

- To pause or resume music, press the power button briefly.
- To switch between Game mode and music playback, double-click the power button.

# Installation Instructions

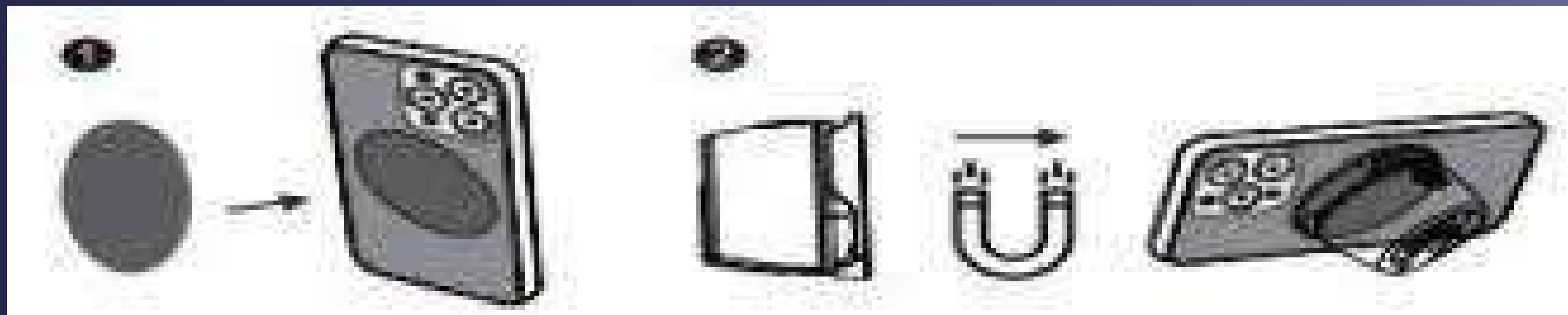

1. For MagSafe compatible iPhone devices or cases, connect the speaker directly to the MagSafe ring.
2. For non-MagSafe devices, attach the included adhesive metal disc to your device, then connect the speaker.

# Charging

Connect the provided USB charging cable to the speaker's Type-C port and a USB power source.

## LED Lights

Turn on the speaker first. To turn the LED lights on or off, press and hold the power button for 3 seconds.

## Included Contents

- 1 x Bluetooth Speaker
- 1 x USB Type-C Charging Cable
- 1 x Adhesive Metal Disc
- 1 x Product User Guide

## Contact Us

If you have any questions about this Privacy Policy, please contact us at:

info@porodo.net

Website: porodo.net

Service Support: support@porodo.net

Instagram: porodo